

abbotFox



Trimingham House, Trimingham, Norwich
Guide Price £55,000

“

We are a team of genuine individuals who hold a deep passion for both property and marketing. Collectively, we bring over 70 years of experience in the property market of Norfolk and Suffolk. Our affection for both counties runs deep, and we are enthusiastic about sharing our passion with you.

Colin McKenzie | **Branch Partner**







THE DETAIL _____

* Pitch Fees Paid Until September 2025*

Guide price £55,000 - £60,000

abbotFox presents this stunning lodge, which enjoys a prime position within the popular Trimmingham House Park development. Situated within easy reach of the meadow, picturesque North Norfolk coast and the Coastal Paths, this lodge enjoys a sense of peace and tranquillity hard to match.

The accommodation on offer is neatly arranged and comprises an spacious open plan living area with fitted kitchen, two double bedrooms, both with walk-in wardrobes, an en-suite shower room to the master and a family bathroom. Externally, the property offers a wrap-around balcony, perfect for enjoying outside dining.

Trimingham House Park is a popular holiday destination, with a 46 week season situated within easy reach of the popular Coastal town of Cromer and the sought after and well serviced village of Mundesley. With excellent on-site facilities including launderette, licensed clubhouse, café / restaurant and heated swimming pool, this is an ideal holiday home.

Agents Note: This is not a fully residential site. All lodge owners must have a permanent residential address.







THE HIGHLIGHTS _____

- Pitch fees paid until September 2025
- Two double bedroom lodge
- Generous open plan living
- Excellent on-site amenities
- Private outside space and parking
- Easy access to Cromer and Mundesley
- Viewing advised

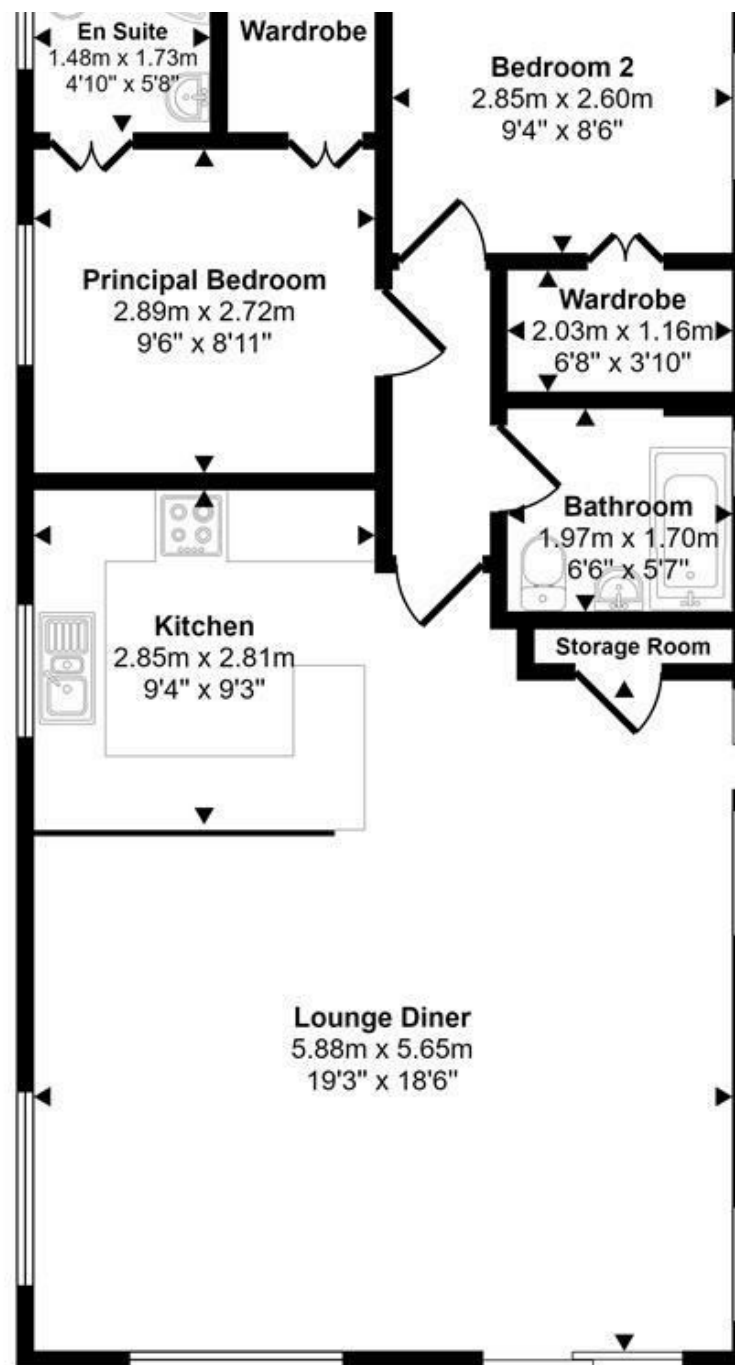

Let's talk

01603 660000

sales@abbotfox.co.uk

@abbotfox

EPC RATING -

Disclaimer – In accordance with the Property Misdescriptions Act, the company abbotFox gives notice that all descriptions, references to condition, necessary permissions for use and other details are given in good faith and believed to be correct, but any purchaser should not rely on them as statements of fact, and must satisfy themselves by inspection or other means, as to their accuracy.